

# USER **MANUAL**

HOW TO USE YOUR PAUL&ERNST PRODUCT



# USER MANUAL

HOW TO USE YOUR PAUL&ERNST PRODUCT

WATCH THE **VIDEO** 



## CONTENT

1. CHARGING THE BATTERY .....	Page 3
2. MAIN PANEL .....	Page 3
3. PARKING BRAKE .....	Page 4
4. SETUP .....	Page 4
5. BIKE DISPLAY .....	Page 5
6. RIDING THE BIKE .....	Page 5
7. WATER SYSTEM.....	Page 6
8. CONNECTIVITY SET .....	Page 7
9. CUP DISPENSER .....	Page 8
10. DRAINING CONDENSED WATER .....	Page 9
11. ICE CREAM SQUARE .....	Page 10
12. ICE CREAM POZZETTI .....	Page 11
13. COOKING .....	Page 12
14. BEVERAGE.....	Page 14
15. TRAILER.....	Page 16
16. PUSH CART .....	Page 17

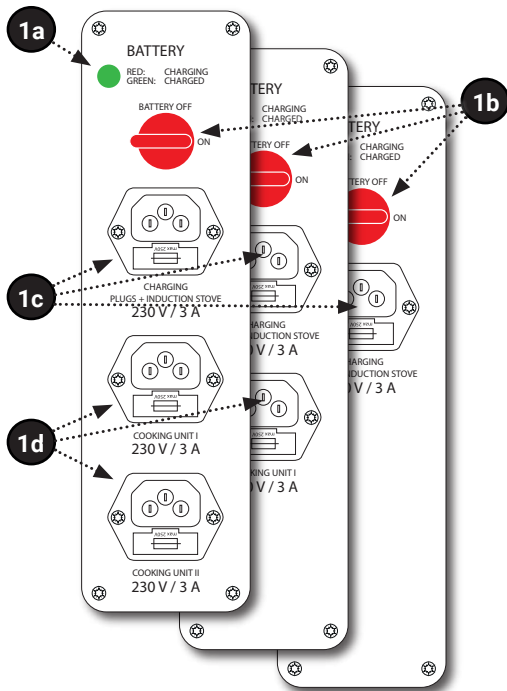

The plugs (1d) are only present on Cooking Bikes. Connect the product to the mains to use the cooking equipment.

## 1 CHARGING THE BATTERY

Plug the power cable (1c) into a 230V socket.

You can set the red main switch (1b) to either on or off, the battery is charging in both positions. The LED (1a) stays red until the battery is fully charged after about 10 hours (green = ready)

**IMPORTANT/CAREFUL!** Always set the switch to **OFF** when handling the plugs (repairs, connections of devices, etc.) and during longer periods of storage (e.g. winter months).

- CHARGING - Battery is charging.
- CHARGED - Battery is fully charged.

### CHARGING TIMES

### RUNNING TIME

Cooling unit at -18°C

<b>S</b> AKKU SIZE	3 h	1.5 h
<b>M</b> AKKU SIZE	6 h	3 h
<b>L</b> AKKU SIZE	8 h	10 h

### NOTE: ⚠

The battery life depends on:

- distance traveled
- outside temperature
- desired cooling temperature
- direct sunlight



We recommend that you charge the battery overnight the day before use and to set the cooling unit to the desired temperature, ideally a few hours before use.

## 2 MAIN PANEL

### MAIN PANEL:

All electric components (2a, 2b, 2c) (FRIDGE, PUMP, PLUGS) that are plugged in may be switched on and off separately via the MAIN PANEL. You can set the exact temperature using the digital refrigerator/freezer display (2f).

### SETTING THE TEMPERATURE:

First, switch on the refrigerator pressing the button (2a). The temperature display (2f) now shows the current temperature. Press the Enter button (2e) and select SET1 or SET2 with the arrow buttons (2d). Confirm your choice again pressing Enter (2e). Select the desired temperature with the arrow buttons (2d) (SET1 and SET2 are two different temperature settings for quick selection). After approx. 10 sec. the settings menu closes and the current temperature is shown again.

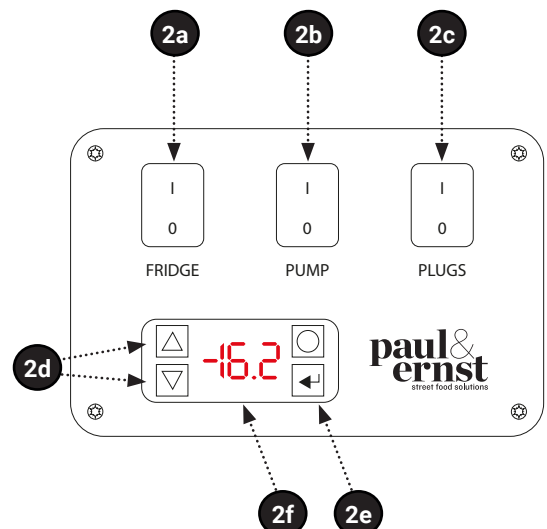



### 3 PARKING BRAKE

To engage the parking brake, hold down the brake firmly (3a) and turn the valve (3b) clockwise to 12 o'clock. To disengage the brake, turn the lock (3b) counterclockwise to 9 o'clock.



Before driving off, make sure that the blue valve (3b) is open again and set to 9 o'clock. Braking is otherwise not possible!

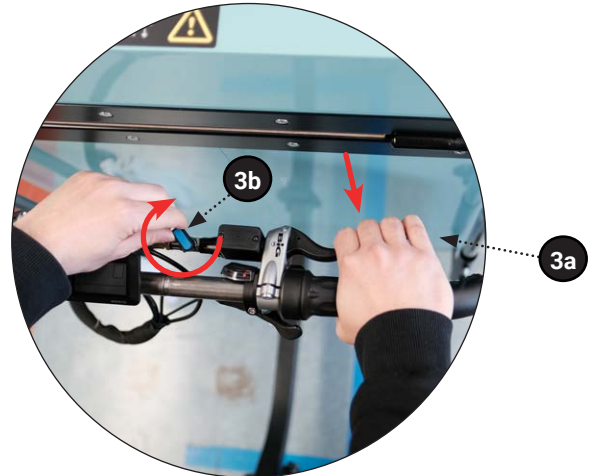

### 4 SETUP

#### SADDEL:

To position the work surface horizontally (4a), lower the saddle (4b) completely.

#### HANDLE BAR: ⚠

**ATTENTION!** Before you open the lid (4c), you must push the handlebar (4d) DOWN. To do this, unscrew the screws (4e), hold down the locking button (4f) and push the handlebar down until it supports the entire bike on the ground. Then tighten the screws (4e) again. Open the lid and place it on the saddle.

#### PARASOL:

Insert the umbrella into the holder (4g) provided for this purpose. Loosen the fastening screw (4h) and push the umbrella upwards to open it. Mind the glass splash guard.

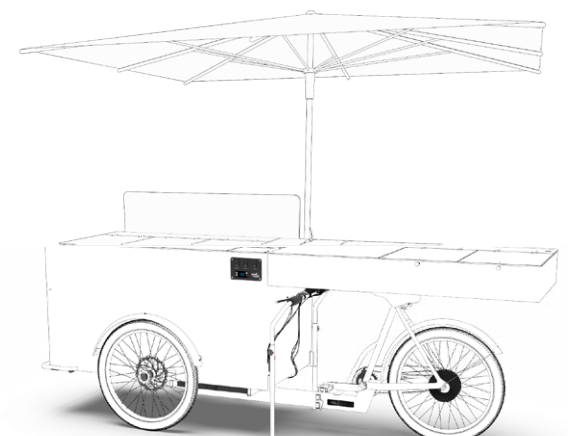
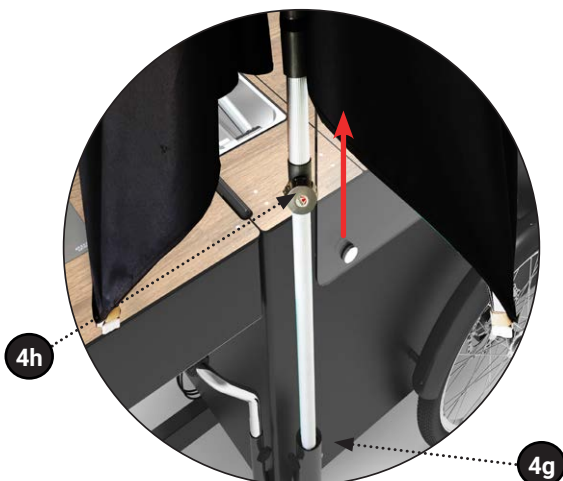
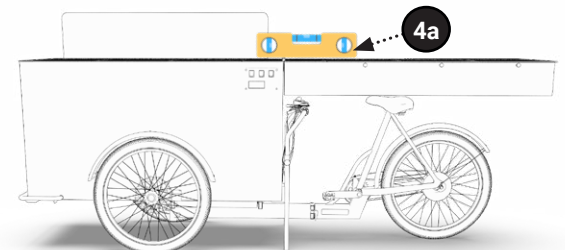
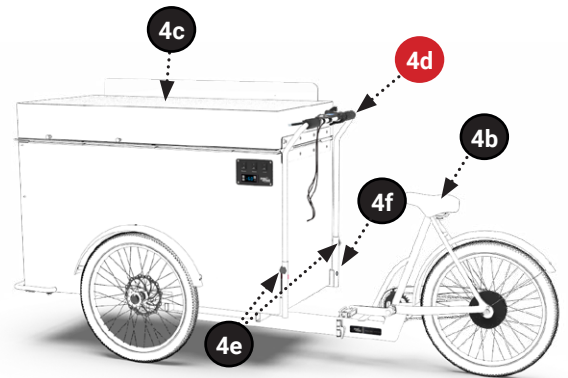



## 5 BIKE DISPLAY

The BAFANG dp c 13.UART display gives you an overview of the most important parameters of your e-bike: battery charge level, assistance level of the electric motor and your current speed. You can also switch on the lights with the display.

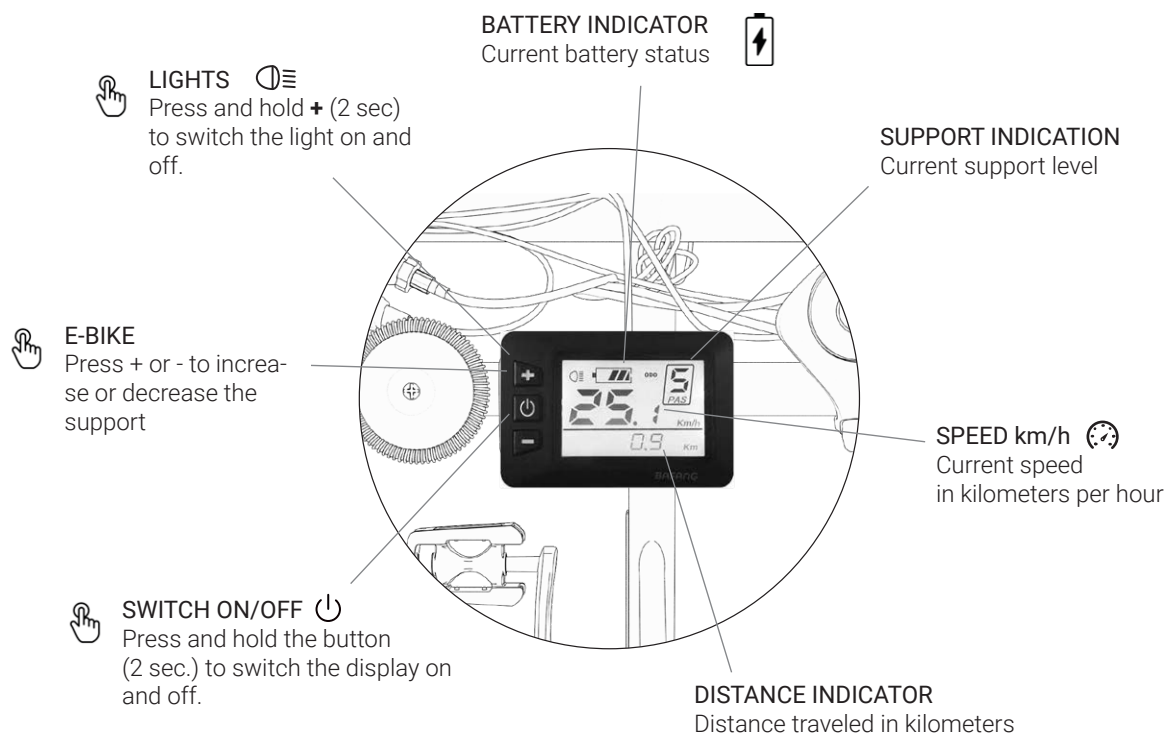

## 6 RIDING THE BIKE

### 6a BOOST ASSISTANCE

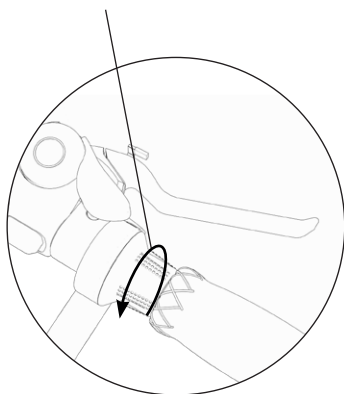

#### DRIVING OFF:

To move off, you may use the boost assistance **(6a)** for support. To do so, turn the right handle. As you pedal, you may use the assistance levels of the electric motor.

#### SHIFTING:

Shifting gears under heavy load (e.g. uphill) usually results in strong creaking or, in extreme cases, even to the chain breaking. To avoid this, gain some momentum before shifting gears, then shift gears under light load, only pedalling hard again when the **shifting process** is complete.



## 7 WATER SYSTEM

The water system works self-sufficiently with the battery, requires little maintenance and is quickly ready for use.

### HOW TO USE IT:

1. Open the flap.
2. Inside you will find two water tanks: the waste water tank (7a) and the fresh water tank (7b).
3. Pull the hose (7c) out of the waste water tank (7a) and remove the waste water tank (7a).
4. Open the safety lock (7d, see Fig. 7.1.) of the fresh water tank (7b).
5. Take out the fresh water tank (7b) and fill it with clean water.
6. Put the filled fresh water tank (7b) back and connect the two ends of the safety lock (7d).
7. Put the waste water tank (7a) back and insert the hose (7c).
8. Close the flap.
9. Flip the switch (7e) labeled PUMP.
10. Your water system is now ready for use.

**Tip** - Alternatively, you can leave the fresh water tank installed and fill it directly with a hose.

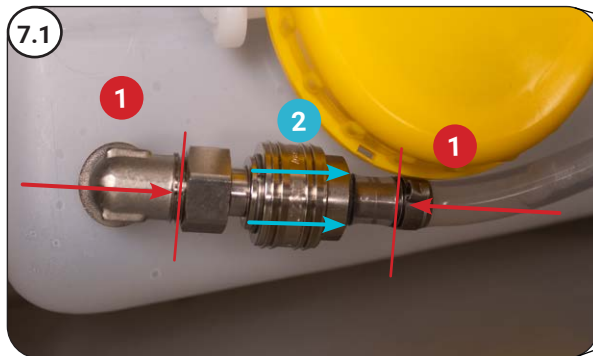

### OPENING SAFETY LOCK (7d): ⚠

1. Squeeze and hold
2. Push back

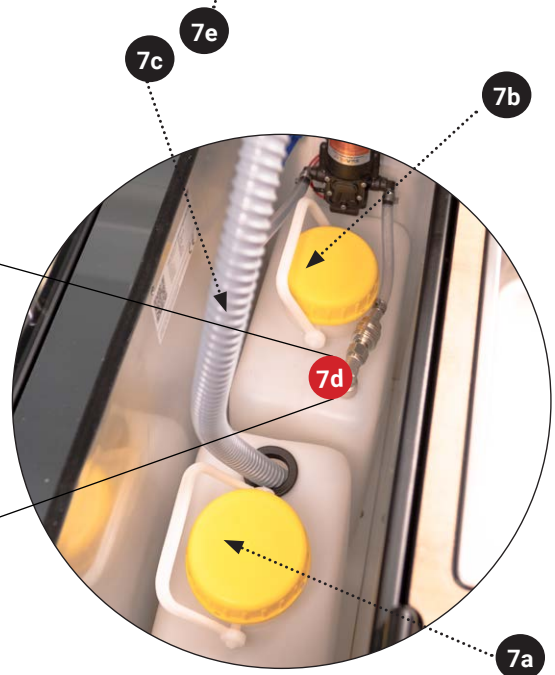

Only fill untreated, clean water into the fresh water tank. Detergents and soap can block the fresh water hose or corrode the safety lock.

To prevent the growth of bacteria and germs, clean the fresh and waste water tank as well as the hoses daily after use. We recommend cleaning all parts with warm water and a mild detergent.



## 8 REINIGUNGSEMPFEHLUNG - WASSERSYSTEM

Das Wassersystem besteht aus Spülbecken, Portionierspüle und Wassercontainer

Materialien: Metall, Kunststoff

### **BENÖTIGTE UTENSILIEN:**

- Nicht ätzendes Reinigungsmittel
- Heißes Wasser (bis 70 Grad Celsius)
- Putzlappen, Schwamm und Stielbürste

### **TÄGLICHE REINIGUNG:**

Vor jeder Benutzung den Wasserhahn aufdrehen und frisches Trinkwasser durch Wasserhahn und Portionierspüle laufen lassen, um Schläuche durchspülen. Nach jeder Benutzung sollte das Waschbecken mit herkömmlichen Reinigungsmitteln gereinigt und mit ausreichend heißem Trinkwasser (bis 70 Grad Celsius) nachspülen. Das Restwasser nach der Reinigung gründlich ablaufen lassen und Becken vollständig trocken wischen.

### **WÖCHENTLICHE REINIGUNG:**

Für die Reinigung der Wassercontainer lebensmittelverträgliches Reinigungsmittel in heißem Wasser (bis 70 Grad Celsius) auflösen und Frischwasser Container mind. bis zur Hälfte damit befüllen (5 L Minimum). Die gesamte Reinigungslösung einmal sowohl durch Wasserhahn als auch Portionierspüle laufen lassen. Anschließend den Frischwasser Container mit ausreichend heißem Trinkwasser (bis 70 Grad Celsius) auffüllen und das Wassersystem noch einmal komplett durchspülen. Der Abwasserbehälter muss im Anschluss entleert werden. Ist der Abwasserbehälter besonders stark verschmutzt, kann auch dieser mit der Reinigungswasser Mischung befüllt werden. Die Einwirkzeit der Reinigungswasser Mischung kann bis zu 24h je nach Verschmutzungsgrad betragen. Anschließend mit einer Stielbürste von innen Schrubben und wieder gut ausspülen.

Das Restwasser nach der Reinigung mit Einmal-Papiertüchern trocken wischen.

### **REINIGUNG VOR DER EINLAGERUNG:**

Wassersystem laut wöchentlicher Reinigungsempfehlung reinigen. Es sollte sich bei einer längeren Lagerung so wenig Wasser wie möglich in den Schläuchen und Containern befinden. Vor jeder Nutzung noch einmal laut wöchentlicher Reinigungsempfehlung reinigen.



## 8 CONNECTIVITY SET

The Connectivity Set works autonomously, is quickly ready for use and maintenance-free.

### YOUR CONNECTIVITY SET CONSISTS OF:

- 1x power socket (230 V) **(8a)**
- 2x USB port (type A; 5 V) **(8b)**
- 1x 3G router **(8c)**
- 1x universal socket (24 V) for mobile POS systems or low voltage printer **(8d)**

### HOW TO USE IT:

1. Set the main switch **(1b, see page 1)** to ON.
2. Flip the switch labeled PLUGS **(8e)**.
3. Your connectivity set is now ready for use.

### WIFI ROUTER:

1. Open the flap.
2. Pull the cable **(8f)** out of the router.
3. The router is attached to your bike with a sturdy Velcro strip.
4. Carefully pull off the router.
5. You will find a small notch on the edge of the router.
6. To open the router housing, insert a slotted screwdriver into the notch.
7. Hold the router firmly and gently turn the screwdriver until the cover comes off.
8. Carefully remove the battery.
9. There is a slot for a standard-sized SIM card under the battery.
10. Insert your SIM card.
11. Put the battery back in and close the router.
12. Press the router firmly against the Velcro strip on the bike.
13. Flip the switch **(8e)** labeled PLUGS.
14. Wait for the router to start.
15. Configure your router according to your mobile carrier's specifications, if necessary.
16. Your router is now ready for use.

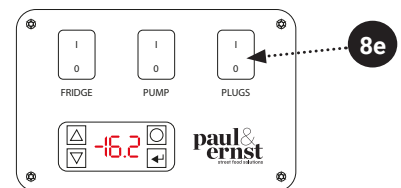
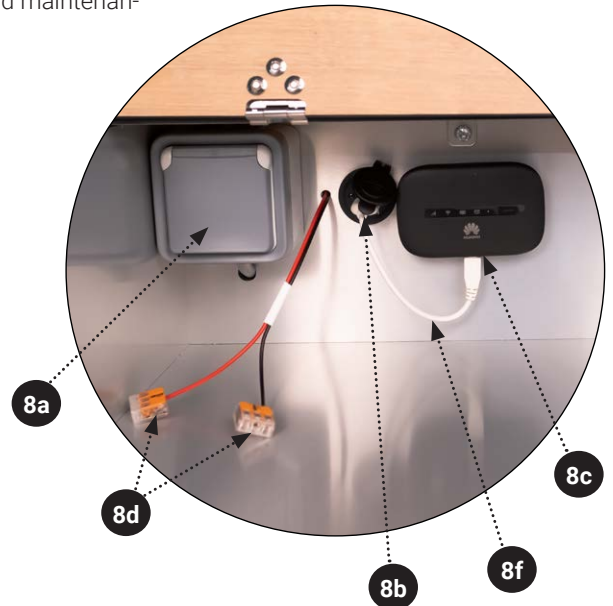

The 230 V socket is not autonomous and only works if your bike is connected to a 230 V power supply by cable.



paul&ernst does not include a SIM card and does not act as a mobile carrier.

Do not connect any storage media to the connectivity set via USB. Always keep the connectivity set dry and clean to avoid short circuits.



## 9 CUP DISPENSER

1. Remove the end ring (**9a**) from the cup/lid dispenser by turning it counterclockwise.
2. Remove the silicone ring and replace it with one that fits your cups. (You will find spare silicon rings in the cotton bag).
3. Fasten the end ring (**9a**) along with the silicone ring (**9b**) by turning it clockwise as far as possible.
4. Fill the dispenser with cups/lids by simply pushing them through the opening of the silicone ring.
5. Your cup dispenser is now ready for use.

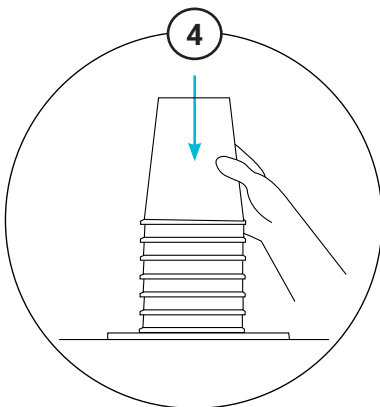
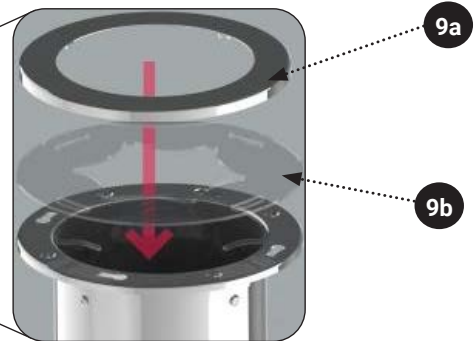
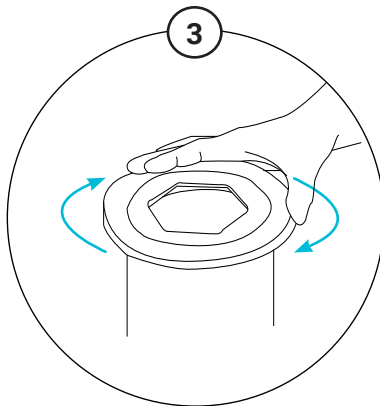
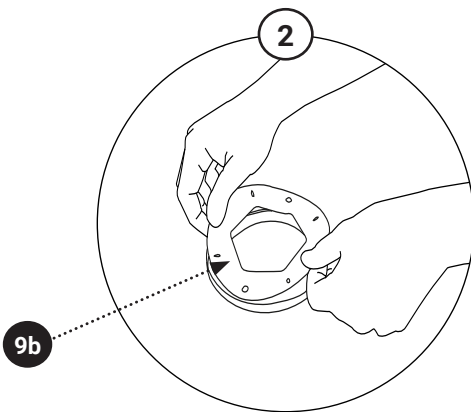
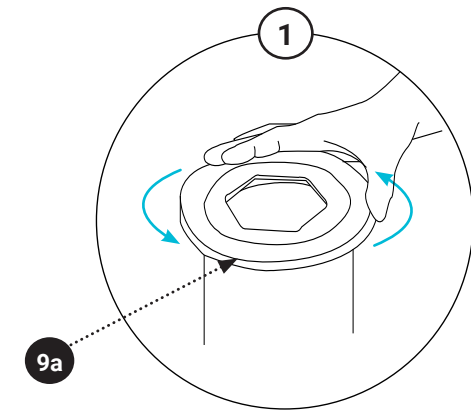



## 10 MAINTENANCE COOLING UNIT - DRAINING CONDENSATION WATER

Our bike models with a cooling/freezing unit come with a drain for condensed water. The description below applies to all bikes with a cooling/freezing unit.

How you drain the condensed water:

1. The valve **(10a)** is located behind the left tire in the direction of travel.
2. Place your model on a waterproof or absorbent surface, or put a suitable container under the valve.
3. Hold the valve with one hand and turn the blue handle until it runs parallelly to the drain.
4. The condensed water will now drain off.

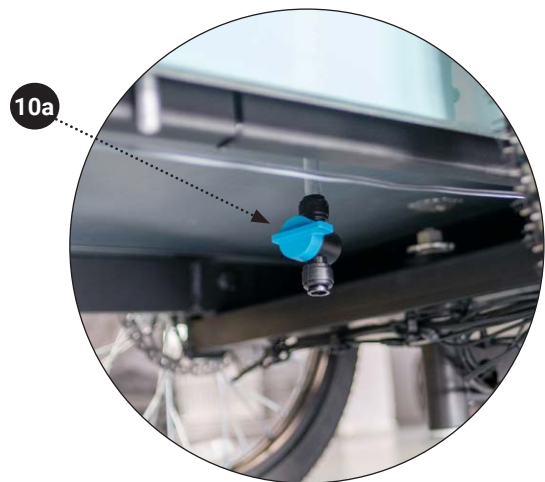

### ⚠️ FAQs

#### Where does the water come from?

Due to the low temperatures in the body of the product, the water contained in the air condenses. This is a natural physical process.

#### Why do I need to drain the water?

It is important to drain the condensed water to prevent the growth of bacteria and germs.

#### When should I drain the water?

We recommend that you drain the water whenever you take your product out of service, i.e. when you turn off the cooling unit.

#### No water is coming out - why?

If you have just turned off the cooling unit, it is possible that parts of the condensed water are still frozen. We recommend leaving your product overnight with the valve open.

## 11 MAINTENANCE COOLING UNIT - CLEANING RECOMMENDATION

The components used are made of plastic (interior) and, if applicable, metal (GN rail and GN containers).

### FOR CLEANING YOU ARE GOING TO NEED THE FOLLOWING EQUIPMENT:

- Mild detergent, e.g. dish soap or neutral soap
- Warm water (up to 40 degrees Celsius)
- Cleaning cloth, sponge, and paper towels
- 

### CLEANING BEFORE FIRST USE:

Wipe down the interior of the cooling unit with warm water and a few drops of detergent. Open the drain valve at the bottom to allow water to drain. Once there is no water left, close the drain valve.

### DAILY CLEANING:

You may clean the interior with food-safe detergents and warm water, scrubbing it lightly to remove food debris. Thoroughly clean the ventilation grids and rubber seals as well. Refrain from using abrasive cleaners on any metal surfaces to avoid scratching. Drain all residual water and wipe the cooling unit completely dry with dry cloths. Once there is no water left, close the drain valve.

### WEEKLY CLEANING:

Turn off the cooling unit, allow it to defrost, and clean it according to „Daily Cleaning“.

### CLEANING BEFORE STORAGE:

Clean the cooling unit according to „Weekly Cleaning“ before storage. The cooling unit needs to stay and be dry during prolonged storage. Clean it before recommission according to „Daily Cleaning“.



## 11 ICE CREAM SQUARE

**CAUTION!** Keep the glass display case (11a) closed at all times to ensure optimal cooling. Fill the freezer unit with as much content as possible: this may be done with filled replacement GNs or, if not available, with a special paul&ernst cooling pad insert.

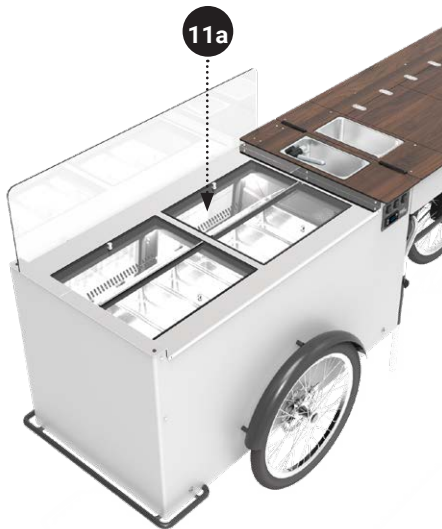

### SETTING THE TEMPERATURE:

1. First, switch on the cooling unit with the button (11b).
2. The temperature display (11e) now shows the current temperature.
3. Press the Enter button (11c) and select SET1 or SET2 with the arrow keys (11d) (SET1 and SET2 are two different temperature settings for quick selection).
4. Confirm the selection with Enter (11c).
5. Select the desired temperature with the arrow keys (11d).
6. After approx. 10 sec. the settings menu closes and the current temperature is shown again.

### NOTE:

- Mass always cools better than air. Choose a shady place if possible.
- Pre-cool the cooling unit to the desired temperature the night before you go on sale.
- Drain condensed water regularly (see Chap. 10).

### TEMPERATURE CHECK:

Check the temperature display of the cooling unit regularly.  
-12°C to about -16°C

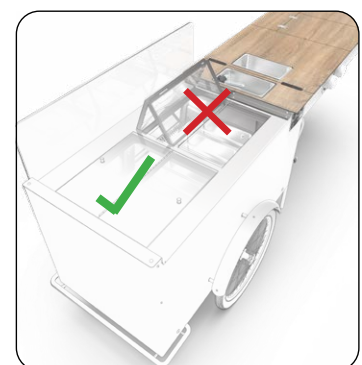
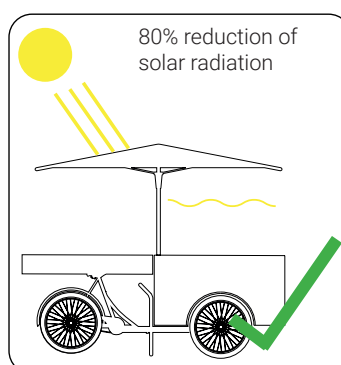
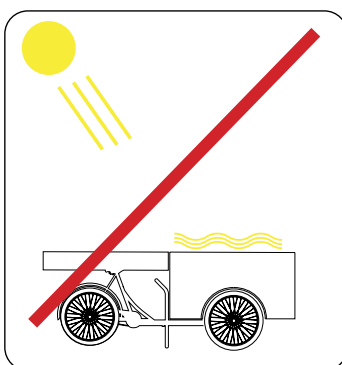
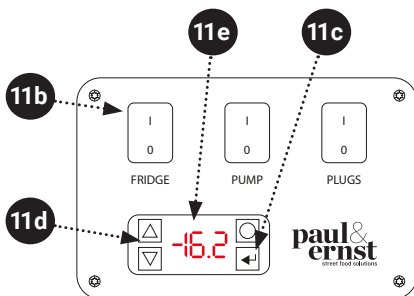

Always keep the glass display case closed - significant energy or cold loss when the display case is open.

We recommend a shadow for the Ice Cream Bike, as strong sunlight over several hours may affect the cooling.



## 12 ICE CREAM POZZETTI



**CAUTION!** Keep the carapinas (12a) closed at all times to ensure optimal cooling. Fill the freezer unit with as much content as possible: this may be done with filled replacement GNs or, if not available, with a special paul&ernst cooling pad insert.

### SETTING THE TEMPERATURE:

1. First, switch on the cooling unit with the button (12b).
2. The temperature display (12e) now shows the current temperature.
3. Press the Enter button (12c) and select SET1 or SET2 with the arrow keys (12d) (SET1 and SET2 are two different temperature settings for quick selection).
4. Confirm the selection with Enter (12c).
5. Select the desired temperature with the arrow keys (12d).
6. After approx. 10 sec. the settings menu closes and the current temperature is shown again.

### NOTE:

- Mass always cools better than air. Choose a shady place if possible.
- Pre-cool the cooling unit to the desired temperature the night before you go on sale.
- Drain condensed water regularly (see Chap. 10).

### TEMPERATURE CHECK:

Check the temperature display of the cooling unit regularly.  
-12°C to about -16°C

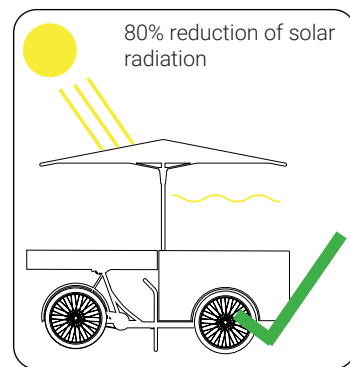
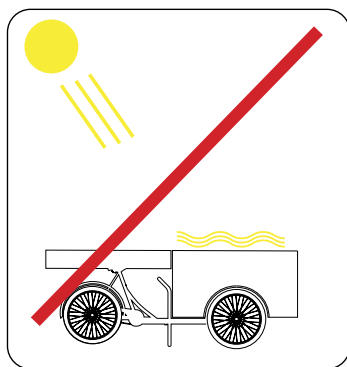
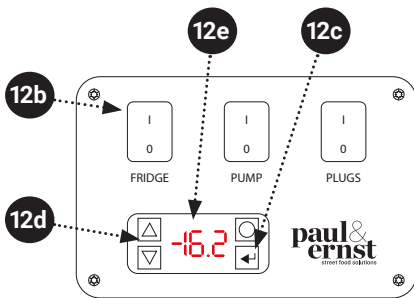

Always keep the carapinas closed - significant energy or cold loss when the display case is open.

We recommend a shadow for the Ice Cream Bike, as strong sunlight over several hours may affect the cooling.



## 13 COOKING

The Cooking Bikes are quickly ready to use. Getting your bike ready varies slightly according to the source of energy (gas or electricity) chosen. However, the description applies to both the Cooking Bike Pro I and Pro II.

How to use the bike with electricity:

1. Plug in the cable, which comes with your product, into the plug **COOKING UNITS** in the product's panel (**13a**). Connect your product to a 230V supply.
2. If applicable, take off your rattan basket (**13b**) or clip-on table. Open the door to the storage room, which you will find underneath the cooking devices (**13c**).
3. The key to the storage room is in the cotton bag.
4. Plug your cooking device into the socket (**13d**) and close the door.
5. Flip the main switch to **ON (13e)**.
6. Your cooking device is now ready to use.

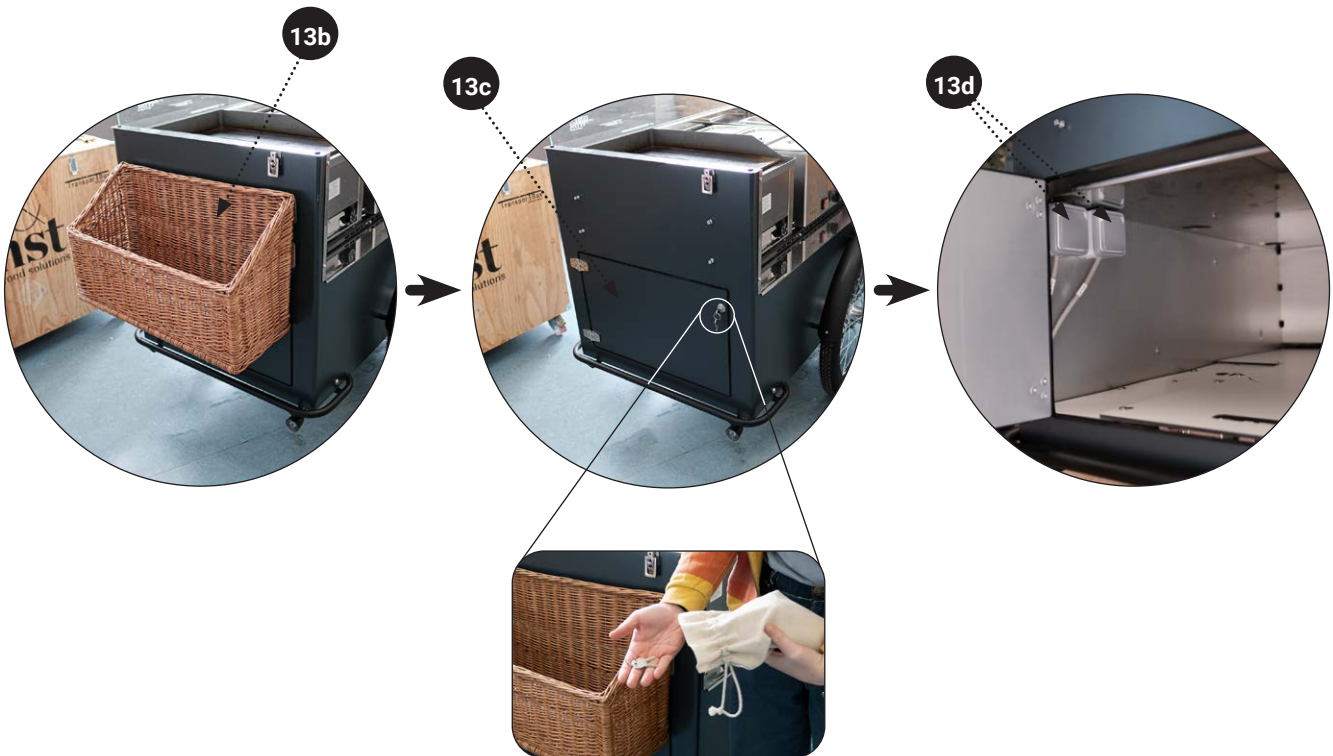
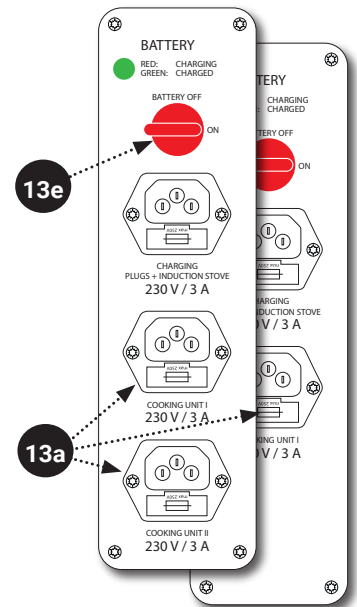

If you have both a gas-powered and electric cooking device, you must never, **UNDER ANY CIRCUMSTANCE**, use them simultaneously! This poses a fire hazard!  
Keep plugs, cables, and sockets clean and dry at all times.

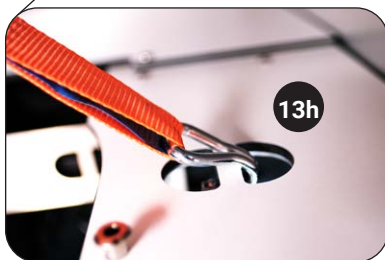
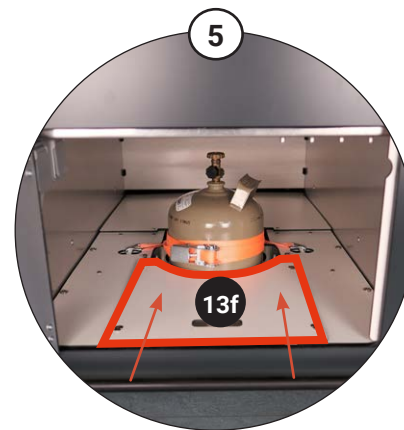
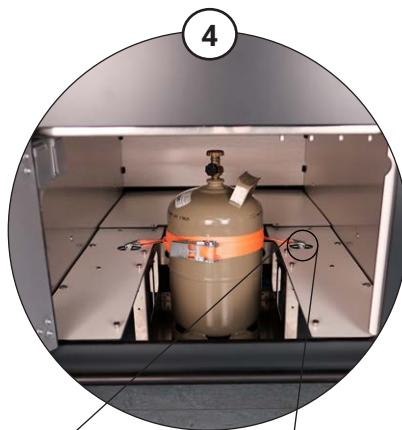
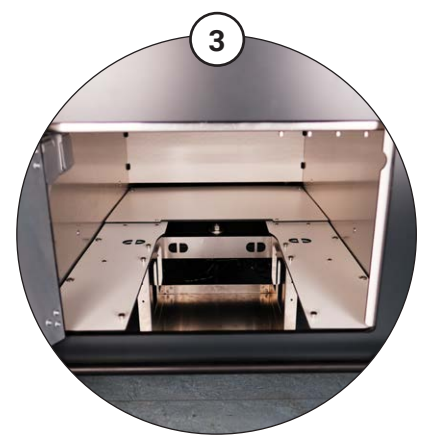
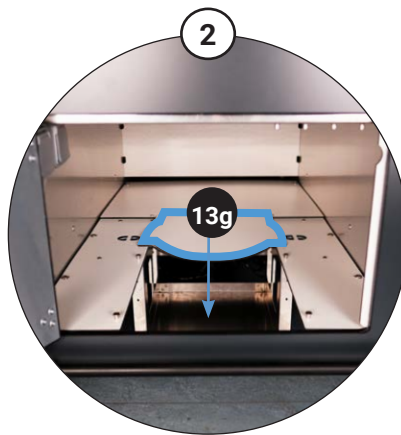
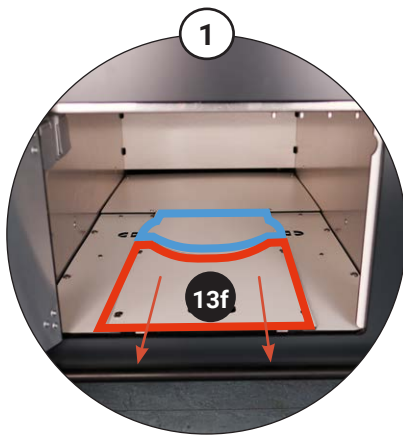

#### INSERTING A GAS BOTTLE:



1. If applicable, take off your rattan basket or clip-on table.
2. Open the door to the storage room, which you will find underneath the cooking device.
3. Pull out the boards (**13f, 13g**) to insert a gas bottle.
4. Place the gas bottle in the designated area and strap it in (**13h**).
5. Attach the hose to the gas bottle.
6. Push the boards (**13f**) back in until they click into place to secure the gas bottle.
7. Your cooking device is now ready to use.



Only have authorized and qualified personell attach the gas bottle to the hose.  
Dilettante and wrong attaching may lead to gas leaks and/or explosion!



## 14 BEVERAGE

You may place GN containers inside the Beverage Bike's fridge (**14a**). Simply insert the GN bar (**14b**) into the designated slots (**14c**).

The GN rack (**14d**) helps you create more space on the counter. You may hang it on the splash guard, facing you when the bike's lid is open. Before closing the lid, stow away your GN rack, e.g. by hanging it over the splash guard facing the buyer or by putting it in the cooling unit.

If desired, you may put more GN containers (**14f**) into the bottle insert (**14e**).

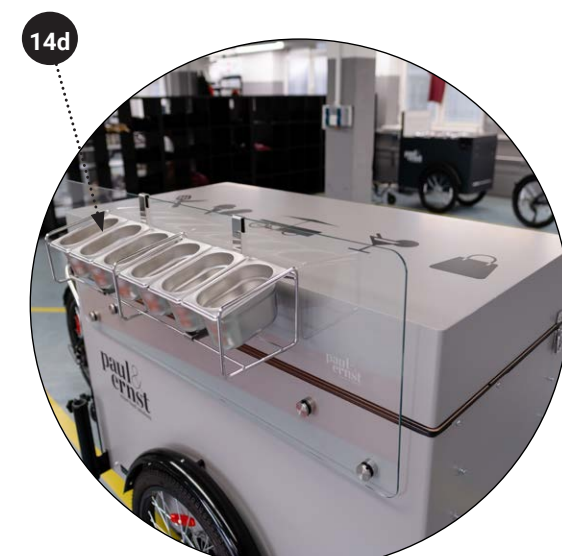
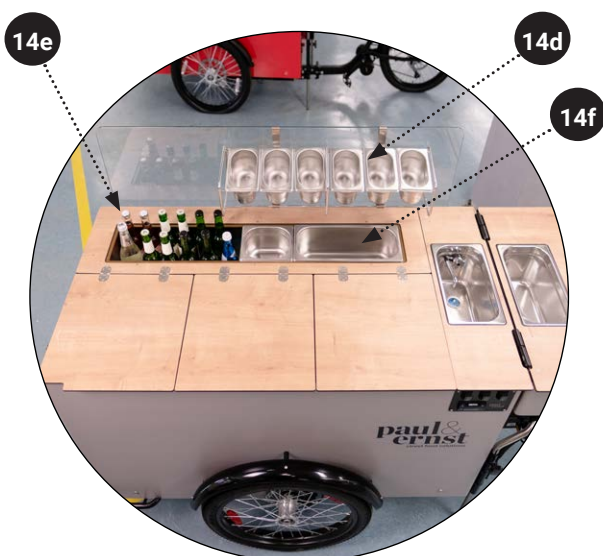
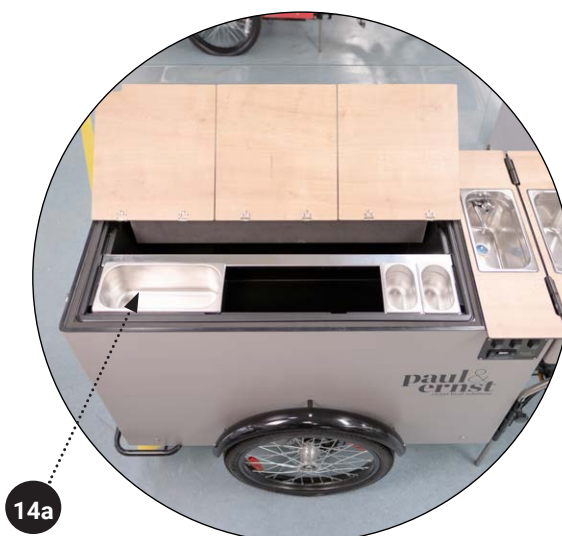
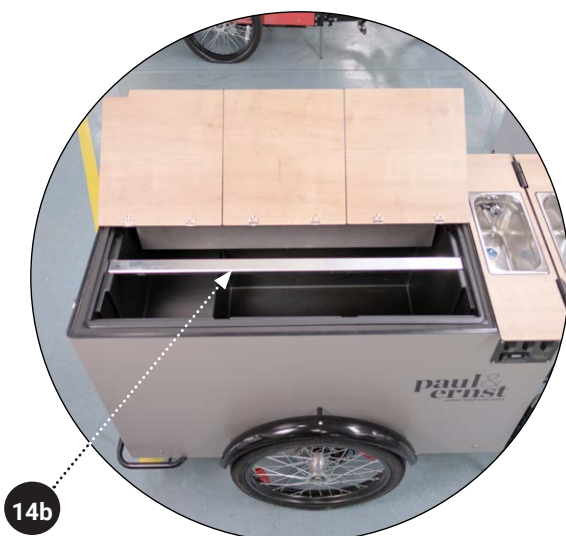
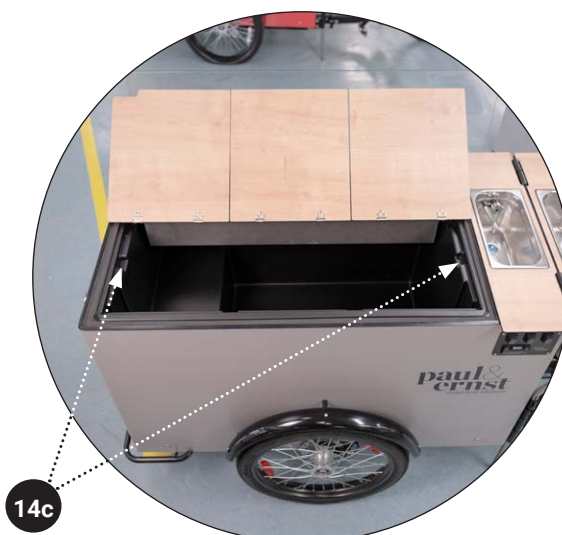



## SETTING THE TEMPERATURE:

1. First, switch on the cooling unit with the button **(14g)**.
2. The temperature display **(14h)** now shows the current temperature.
3. Press the Enter button **(14i)** and select SET1 or SET2 with the arrow keys **(14j)** (SET1 and SET2 are two different temperature settings for quick selection).
4. Confirm the selection with Enter **(14i)**.
5. Select the desired temperature with the arrow keys **(14j)**.
6. After approx. 10 sec. the settings menu closes and the current temperature is shown again.

## NOTE:

- Mass always cools better than air. Choose a shady place if possible.
- Pre-cool the cooling unit to the desired temperature the night before you go on sale.
- Drain condensed water regularly **(see Chap. 10)**.

## TEMPERATURE CHECK:

Check the temperature display of the cooling unit regularly.

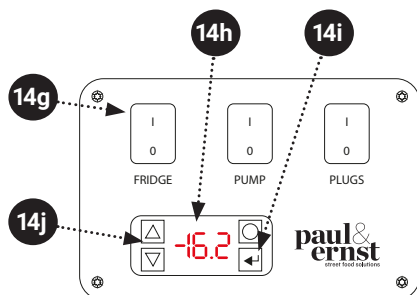



## 15 TRAILER

**ATTENTION!** The **paul&ernst** Trailer does not come with a separate brake system!

### Docking:

1. Press the safety button on the handle and turn it to the left.
2. Connect the handle and coupling. Make sure that the flat surfaces of the coupling and the fitting are aligned with each other.
3. Turn the handle to the right until you hear a clear click sound. Only then the coupling is locked and secured.
4. For couplings with lock, lock the coupling with the supplied key..
5. Place the arrester around the rear stay of the bike. Wrap the arrester around the fastener and close it by pressing. The arrester should have enough play so that it does not influence the steering behavior of the trailer.



### Undocking:

1. Open and unwrap the arrester.
2. Press the safety button and turn the handle.
3. Pull the drawbar off the coupling.

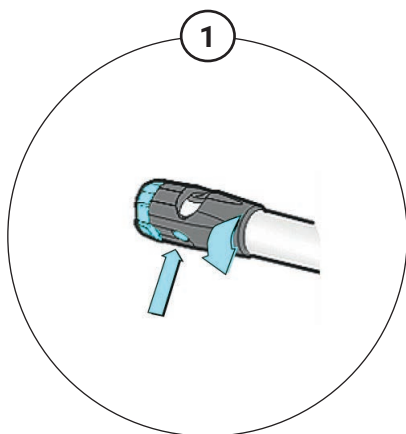

Press and turn safety button

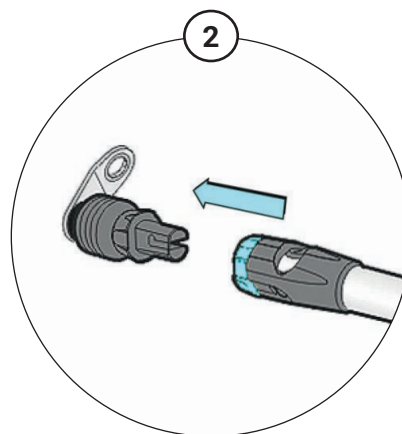

Connect

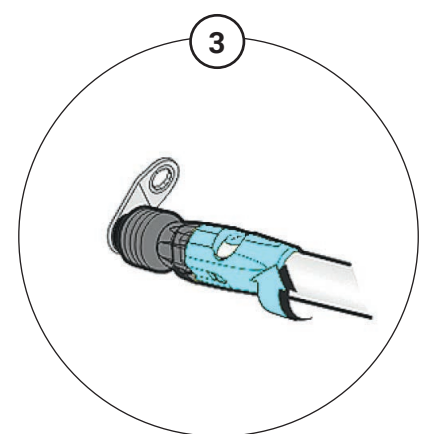

Turn until safety button clicks into place

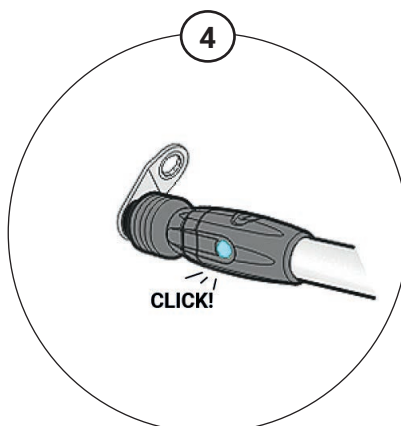

Noticeable 'click' sound

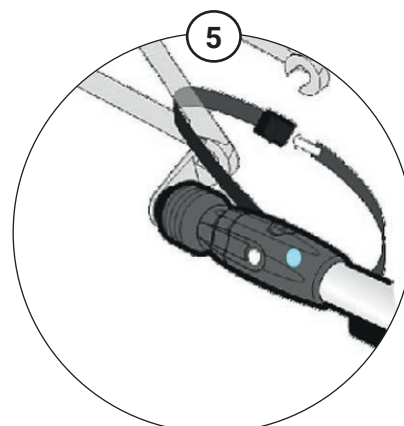

Buckle up arrester



## 16 PUSHCART

**ATTENTION!** The **paul&ernst** Pushcart is designed for activities indoor and outdoor, i.e. bars, restaurants, patios, and pedestral areas.

**Not suitable for steep terrain (>10% inclination)!**

**Brakes:** The Pushcart has a mechanical brake with parking mode. It does not come with automatic brakes. Make sure the Pushcart stands still and steady at all times.

**Note:**

- Choose a flat area.
- Check if the parking brake is engaged!



Not suitable for steep terrain!